

PROJECT OVERVIEW

North Lake Drive Reconstruction Project



The City of Milwaukee, in partnership with the Wisconsin Department of Transportation (WisDOT), is preparing to reconstruct North Lake Drive, from East Newberry Boulevard to East Edgewood Avenue. The following is scheduled to take place as part of this project.

Upcoming Project Work

- Removing and replacing deteriorated pavement, curb and gutter, driveway approaches and sidewalk
- Constructing ADA-compliant curb ramps
- Enhancing pedestrian and bike accommodations
- Upgrading drainage structures, street lighting and traffic signals

The project is scheduled to take place in two phases in 2024 and 2025.

2024 Construction

North Lake Drive, **between East Kenwood Boulevard and East Edgewood Avenue**, is scheduled to be reconstructed in 3 stages. One southbound lane will be maintained for local traffic only.

2025 Construction

North Lake Drive, **between East Newberry Boulevard and East Kenwood Boulevard**, is scheduled to be reconstructed in 3 stages. One southbound lane will be maintained for local traffic only.

Access to business and residences will be maintained.

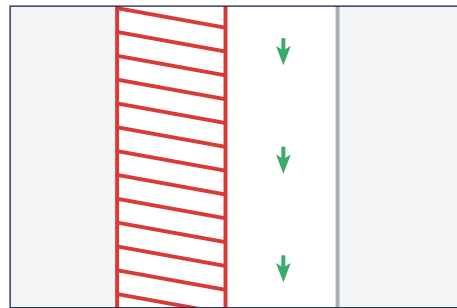

STAGE 1

STAGE 4

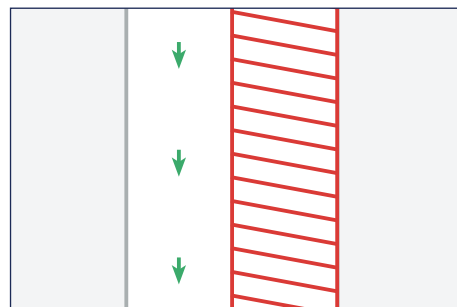

STAGE 2

STAGE 5

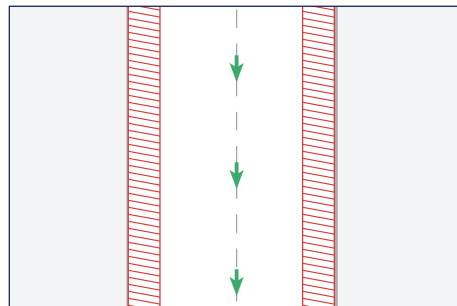

STAGE 3

STAGE 6



Project Contact

Public Involvement

Alyssa Tapia



phone
414-255-5658



email
mkeprojects@devorpr.com

The project team thanks you for your patience and cooperation throughout this project!

Sign Up for Updates

Use the link below or scan the QR code to receive updates on the construction project.



milwaukee.gov/lakedrive